

# RECORD OF SURVEY No. 31-61

IN THE UNINCORPORATED TERRITORY OF THE COUNTY OF MONO, STATE OF CALIFORNIA,  
BEING SECTIONS 21, 22, 27-30, 35 & 36, TOGETHER WITH THE SOUTHERLY TOWNSHIP LINE  
FROM SECTION 33 TO 36, TOWNSHIP 7 NORTH, RANGE 23 EAST, MOUNT DIABLO MERIDIAN

MONUMENT DESCRIPTIONS:

220220

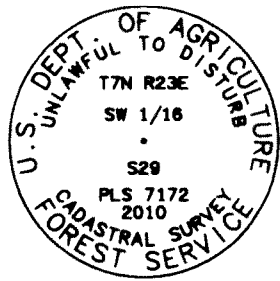

SET A STANDARD US FOREST SERVICE ALUMINUM MONUMENT WITH A 3/4 INCH DIAMETER ALUMINUM CAP, STAMPED AS SHOWN, ON A 2 1/2 INCH DIAMETER POST, 30 INCHES LONG, 24 INCHES IN THE GROUND, ENCIRCLED BY A MOUND OF STONES, 3.0 FEET IN DIAMETER AND 6 INCHES ABOVE THE GROUND. PLACED A PLASTIC ENCASED MAGNET BENEATH THE MONUMENT. SET A U CHANNEL ALUMINUM POST WITH FOREST SERVICE 54-9 MONUMENT SIGN AND A FOREST SERVICE 54-2 BOUNDARY SIGN, 2.5 FEET SOUTHEASTERLY. SET NEW BEARING TREES SCRIBED "BT", WITH 6" MAG SPIKE AND "PLS 7172" STAINLESS STEEL WASHER FOR CHAINING POINT AT CENTER RIGHT SIDE, AND FOREST SERVICE 54-3 BEARING TREE SIGN:

BT1: A 36 INCH JUNIPER, N27E, 45.2 FEET  
BT2: AN 18 INCH JUNIPER, N48W, 28.3 FEET

220240

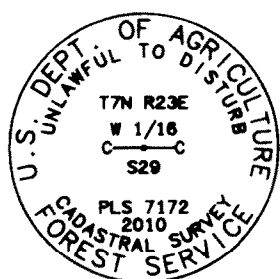

SET A STANDARD US FOREST SERVICE ALUMINUM MONUMENT WITH A 3/4 INCH DIAMETER ALUMINUM CAP, STAMPED AS SHOWN, ON A 2 1/2 INCH DIAMETER POST, 30 INCHES LONG, 24 INCHES IN THE GROUND, ENCIRCLED BY A MOUND OF STONES, 3.0 FEET IN DIAMETER AND 6 INCHES ABOVE THE GROUND. PLACED A PLASTIC ENCASED MAGNET BENEATH THE MONUMENT. SET A U CHANNEL ALUMINUM POST WITH FOREST SERVICE 54-9 MONUMENT SIGN AND A FOREST SERVICE 54-2 BOUNDARY SIGN, 2.0 FEET EASTERLY. SET NEW BEARING TREES SCRIBED "BT", WITH 6" MAG SPIKE AND "PLS 7172" STAINLESS STEEL WASHER FOR CHAINING POINT AT CENTER RIGHT SIDE, AND FOREST SERVICE 54-3 BEARING TREE SIGN:

BT1: A 12 INCH WHITE FIR, N84E, 4.6 FEET  
BT2: A 14 INCH WHITE FIR, S33W, 26.6 FEET

220260



SET A STANDARD US FOREST SERVICE ALUMINUM MONUMENT WITH A 3/4 INCH DIAMETER ALUMINUM CAP, STAMPED AS SHOWN, ON A 2 1/2 INCH DIAMETER POST, 30 INCHES LONG, 24 INCHES IN THE GROUND, ENCIRCLED BY A MOUND OF STONES, 3.0 FEET IN DIAMETER AND 6 INCHES ABOVE THE GROUND. PLACED A PLASTIC ENCASED MAGNET BENEATH THE MONUMENT. SET A U CHANNEL ALUMINUM POST WITH FOREST SERVICE 54-9 MONUMENT SIGN AND A FOREST SERVICE 54-2 BOUNDARY SIGN, 2.0 FEET NORTHEASTERLY. SET NEW BEARING TREES SCRIBED "BT", WITH 6" MAG SPIKE AND "PLS 7172" STAINLESS STEEL WASHER FOR CHAINING POINT AT CENTER RIGHT SIDE, AND FOREST SERVICE 54-3 BEARING TREE SIGN:

BT1: A 10 INCH FIR, N19E, 15.7 FEET  
BT2: A 21 INCH JEFFREY PINE, N89E, 35.9 FEET

220300

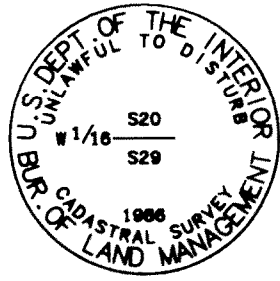

FOUND A 2 1/2 INCH STAINLESS STEEL PIPE WITH A 3/4 INCH BRASS CAP STAMPED AS SHOWN, ENCIRCLED BY A MOUND OF STONES, 3.5 FEET IN DIAMETER AND 13 INCHES ABOVE THE GROUND. FOUND THE MONUMENT IN FAIR CONDITION, LEANING SLIGHTLY. STRAIGHTENED THE MONUMENT AND REBUILT MOUND OF STONES TO 4.0 FEET IN DIAMETER AND 13 INCHES ABOVE THE GROUND. SET A U CHANNEL ALUMINUM POST WITH A FOREST SERVICE 54-9 MONUMENT SIGN, 1.5 FEET SOUTHERLY. FOUND 1986 BEARING TREES:

BT1: A 44 INCH JEFFREY PINE, N28E, 26.0 FEET  
BT2: A 12 INCH FIR, S66E, 12.7 FEET

ADDED, TO EACH TREE, A FOREST SERVICE 54-3 BEARING TREE SIGN AND A 6" MAG SPIKE AND "PLS 7172" STAINLESS STEEL WASHER FOR A CHAINING POINT AT CENTER RIGHT SIDE. NO NEW BEARING TREES ESTABLISHED.

240200

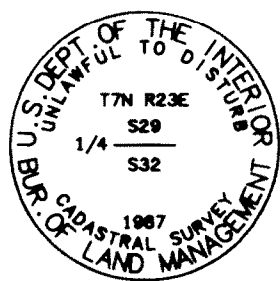

FOUND A 2 1/2 STAINLESS STEEL IRON PIPE WITH A 3/4 BRASS CAP STAMPED AS SHOWN, ENCIRCLED BY A MOUND OF STONES, 3.0 FEET IN DIAMETER AND 18 INCHES ABOVE THE GROUND. FOUND THE MONUMENT IN FAIR CONDITION, LEANING SLIGHTLY DOWNHILL, STRAIGHTENED THE MONUMENT AND REBUILT MOUND OF STONES TO 3.0 FEET IN DIAMETER AND 18 INCHES ABOVE THE GROUND. SET A U CHANNEL ALUMINUM POST WITH A FOREST SERVICE 54-9 MONUMENT SIGN, 1.5 FEET SOUTHERLY. FOUND 1987 BEARING TREES:

BT1: A 22 INCH JEFFREY PINE, N25E, 194.6 FEET  
BT2: AN 82 INCH JUNIPER, S12E, 126.7 FEET

ADDED, TO EACH TREE, A FOREST SERVICE 54-3 BEARING TREE SIGN AND A 6" MAG SPIKE AND "PLS 7172" STAINLESS STEEL WASHER FOR A CHAINING POINT AT CENTER RIGHT SIDE. NO NEW BEARING TREES ESTABLISHED

240300

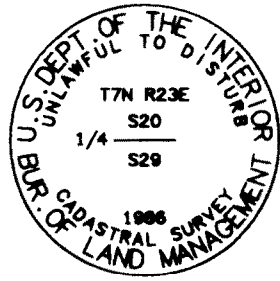

FOUND A 2 1/2 INCH STAINLESS STEEL PIPE WITH A 3/4 BRASS CAP STAMPED AS SHOWN, ENCIRCLED BY A LOOSE MOUND OF STONES, 3.0 FEET IN DIAMETER AND 6 INCHES ABOVE THE GROUND. FOUND THE MONUMENT IN EXCELLENT CONDITION, STRAIGHT AND SOLID, REBUILT MOUND OF STONES. SET A U CHANNEL ALUMINUM POST WITH A FOREST SERVICE 54-9 MONUMENT SIGN, 2.0 FEET EASTERLY. FOUND ORIGINAL BEARING TREE:

BT1: A 27 INCH DEAD WHITE FIR, N33E, 26.5 FEET

FOUND 1986 BEARING TREE:

BT2: AN 18 INCH WHITE FIR, S36E, 15.6 FEET

ADDED, TO THE LIVE TREE, A FOREST SERVICE 54-3 BEARING TREE SIGN AND A 6" MAG SPIKE AND "PLS 7172" STAINLESS STEEL WASHER FOR A CHAINING POINT AT CENTER RIGHT SIDE. SET A NEW BEARING TREE SCRIBED "BT", WITH 6" MAG SPIKE AND "PLS 7172" STAINLESS STEEL WASHER FOR CHAINING POINT AT CENTER RIGHT SIDE, AND FOREST SERVICE 54-3 BEARING TREE SIGN:

BT3: A 16 INCH WHITE FIR, S56W, 17.0 FEET

MONUMENT DESCRIPTIONS:

300100

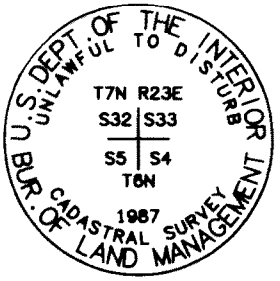

FOUND A 2 1/2 INCH STAINLESS STEEL PIPE WITH A 3/4 BRASS CAP STAMPED AS SHOWN, ENCIRCLED IN A MOUND OF STONES, 4.0 FEET IN DIAMETER AND 12 INCHES ABOVE THE GROUND. FOUND THE MONUMENT IN GOOD CONDITION, REBUILT MOUND OF STONES. SET A U CHANNEL ALUMINUM POST WITH A FOREST SERVICE 54-9 MONUMENT SIGN, 2.0 FEET EASTERLY. FOUND ORIGINAL BEARING TREES:

BT1: A 40 INCH JUNIPER, N16W, 90.0 FEET  
BT2: A 60 INCH JUNIPER, N49E, 147.5 FEET  
BT3: A 40 INCH DEAD AND FALLEN YELLOW PINE, S05W, 268.6 FEET

FOUND 1987 BEARING TREES:

BT4: A 22 INCH JUNIPER, S12E, 139.4 FEET  
BT5: A 28 INCH JUNIPER, S27W, 109.5 FEET

ADDED, TO THE LIVE TREES, A FOREST SERVICE 54-3 BEARING TREE SIGN AND A 6" MAG SPIKE AND "PLS 7172" STAINLESS STEEL WASHER FOR A CHAINING POINT AT CENTER RIGHT SIDE. SET A NEW BEARING TREE SCRIBED "BT", WITH 6" MAG SPIKE AND "PLS 7172" STAINLESS STEEL WASHER FOR CHAINING POINT AT CENTER RIGHT SIDE, AND FOREST SERVICE 54-3 BEARING TREE SIGN:

BT6: A 6 INCH YELLOW PINE, N29E, 81.2 FEET

300200

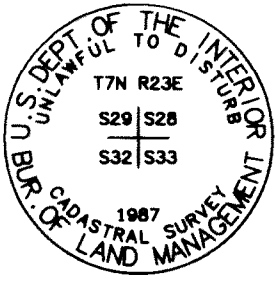

FOUND A 2 1/2 INCH STAINLESS STEEL PIPE WITH A 3/4 BRASS CAP STAMPED AS SHOWN, ENCIRCLED BY A MOUND OF STONES, 4.0 FEET IN DIAMETER AND 18 INCHES ABOVE THE GROUND. FOUND THE MONUMENT IN EXCELLENT CONDITION, STRAIGHT AND SOLID, REBUILT MOUND OF STONES. SET A U CHANNEL ALUMINUM POST WITH A FOREST SERVICE 54-9 MONUMENT SIGN, 2.0 FEET NORTHERLY.

FOUND ORIGINAL BEARING TREE:

BT1: A 40 INCH JUNIPER, N08W, 42.2 FEET

ADDED TO TREE, A FOREST SERVICE 54-3 BEARING TREE SIGN AND A 6" MAG SPIKE AND "PLS 7172" STAINLESS STEEL WASHER FOR A CHAINING POINT AT CENTER RIGHT SIDE. FOUND 1987 BEARING OBJECTS:

B01: A 3 FOOT X 3 FOOT X 4 FOOT HIGH GRANITE BOULDER MARKED "BXO", S48W, 14.2 FEET  
B02: A 6 FOOT X 4 FOOT X 1 FOOT HIGH GRANITE BOULDER MARKED "BXO", N01E, 17.9 FEET

300240

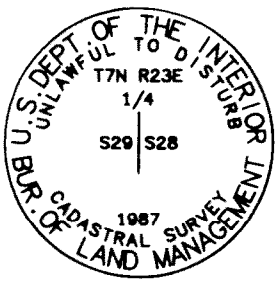

FOUND A 2 1/2 INCH STAINLESS STEEL PIPE WITH A 3/4 BRASS CAP STAMPED AS SHOWN, 2 INCHES ABOVE THE TOP OF A MOUND OF STONES, 4.5 FEET IN DIAMETER AND 16 INCHES ABOVE THE GROUND. FOUND THE MONUMENT IN FAIR CONDITION, LEANING SLIGHTLY, STRAIGHTENED THE MONUMENT AND REBUILT MOUND OF STONES TO 4.5 FEET IN DIAMETER AND 18 INCHES ABOVE THE GROUND. SET A U CHANNEL ALUMINUM POST WITH A FOREST SERVICE 54-9 MONUMENT SIGN, 2.0 FEET EASTERLY. FOUND 1987 BEARING TREE:

BT1: A 17 INCH JEFFREY PINE, S64E, 33.0 FEET

ADDED TO TREE, A FOREST SERVICE 54-3 BEARING TREE SIGN AND A 6" MAG SPIKE AND "PLS 7172" STAINLESS STEEL WASHER FOR A CHAINING POINT AT CENTER RIGHT SIDE. FOUND 1987 BEARING OBJECT:

B01: A 19 FOOT X 7 FOOT FRACTURED GRANITE SURFACE, FLUSH WITH THE GROUND, MARKED "BXO", S47W, 14.7 FEET

300300



FOUND A 2 1/2 INCH STAINLESS STEEL PIPE WITH A 3/4 BRASS CAP STAMPED AS SHOWN, ENCIRCLED BY A MOUND OF STONES, 4.0 FEET IN DIAMETER AND 8 INCHES ABOVE THE GROUND. FOUND THE MONUMENT IN FAIR CONDITION, LEANING SLIGHTLY. STRAIGHTENED THE MONUMENT AND REBUILT MOUND OF STONES. SET A U CHANNEL ALUMINUM POST WITH A FOREST SERVICE 54-9 MONUMENT SIGN AND A FOREST SERVICE 54-2 BOUNDARY SIGN, 2.0 FEET SOUTHWESTERLY. ALL ORIGINAL BEARING TREES DESTROYED BY FIRE AND NO NEW BEARING TREES ESTABLISHED

300320

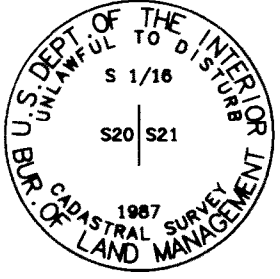

FOUND A 2 1/2 INCH STAINLESS STEEL PIPE WITH A 3/4 BRASS CAP STAMPED AS SHOWN, ENCIRCLED BY A MOUND OF STONES, 4.0 FEET IN DIAMETER AND 6 INCHES ABOVE THE GROUND. FOUND THE MONUMENT IN EXCELLENT CONDITION, STRAIGHT AND SOLID, REBUILT MOUND OF STONES. SET A U CHANNEL ALUMINUM POST WITH A FOREST SERVICE 54-9 MONUMENT SIGN AND A FOREST SERVICE 54-2 BOUNDARY SIGN, 1.5 FEET NORTHWESTERLY. NO EVIDENCE OF 1987 BEARING TREES FOUND. SET NEW BEARING TREES SCRIBED "BT", WITH 6" MAG SPIKE AND "PLS 7172" STAINLESS STEEL WASHER FOR CHAINING POINT AT CENTER RIGHT SIDE, AND FOREST SERVICE 54-3 BEARING TREE SIGN:

BT1: A 32 INCH YELLOW PINE, N60W, 37.9 FEET  
BT2: A 24 INCH YELLOW PINE, N20E, 58.6 FEET

300340

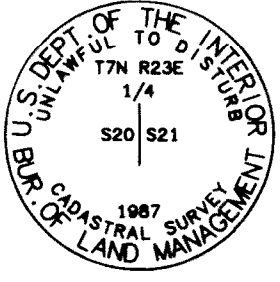

FOUND A 2 1/2 INCH STAINLESS STEEL PIPE WITH A 3/4 BRASS CAP STAMPED AS SHOWN, ENCIRCLED BY A MOUND OF STONES, 2.0 FEET IN DIAMETER AND 6 INCHES ABOVE THE GROUND. FOUND THE MONUMENT IN EXCELLENT CONDITION, STRAIGHT AND SOLID, REBUILT MOUND OF STONES. SET A U CHANNEL ALUMINUM POST WITH A FOREST SERVICE 54-9 MONUMENT SIGN, 2.5 FEET SOUTHERLY. FOUND ORIGINAL BEARING TREES:

BT1: A 32 INCH JEFFREY PINE, N31E, 52.3 FEET  
BT2: A 36 INCH JEFFREY PINE, S70W, 49.4 FEET

ADDED, TO EACH TREE, A FOREST SERVICE 54-3 BEARING TREE SIGN AND A 6" MAG SPIKE AND "PLS 7172" STAINLESS STEEL WASHER FOR A CHAINING POINT AT CENTER RIGHT SIDE. NO NEW BEARING TREES ESTABLISHED

MONUMENT DESCRIPTIONS:

300400

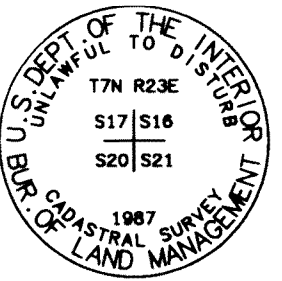

FOUND A 2 1/2 INCH STAINLESS STEEL PIPE WITH A 3/4 BRASS CAP STAMPED AS SHOWN, ENCIRCLED BY A MOUND OF STONES, 3.0 FEET IN DIAMETER AND 5 INCHES ABOVE THE GROUND. FOUND THE MONUMENT IN EXCELLENT CONDITION, STRAIGHT AND SOLID, REBUILT MOUND OF STONES. SET A U CHANNEL ALUMINUM POST WITH A FOREST SERVICE 54-9 MONUMENT SIGN, 2.0 FEET SOUTHWESTERLY. FOUND ORIGINAL BEARING TREES:

BT1: A BROKEN, DEAD STUMP, S75E, 80.0 FEET  
BT2: A BROKEN, DEAD STUMP, S69W, 67.0 FEET  
BT3: A 48 INCH JEFFREY PINE, N75W, 93.0 FEET

FOUND 1987 BEARING TREE:

BT4: A BURNED STUMP WITH BLAZE, N60E, 26.9 FEET

ADDED, TO BT3, A FOREST SERVICE 54-3 BEARING TREE SIGN AND A 6" MAG SPIKE AND "PLS 7172" STAINLESS STEEL WASHER FOR A CHAINING POINT AT CENTER RIGHT SIDE. NO NEW BEARING TREES ESTABLISHED

340100

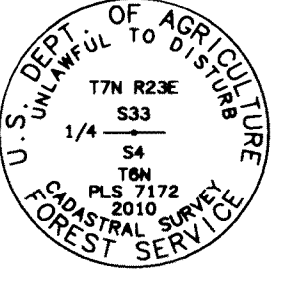

ESTABLISHED BY SINGLE PROPORTION ALONG THE LATITUDINAL ARC BETWEEN 300100 TO THE WEST, AND 500100 TO THE EAST. SET A STANDARD US FOREST SERVICE 3/4 INCH DIAMETER ALUMINUM CAP WITH MAGNET, STAMPED AS SHOWN, DRILLED INTO THE TOP OF A ROCK SHELF. SET A U CHANNEL ALUMINUM POST WITH FOREST SERVICE 54-9 MONUMENT SIGN, 2.0 FEET NORTHERLY. SET NEW BEARING TREES SCRIBED "BT", WITH 6" MAG SPIKE AND "PLS 7172" STAINLESS STEEL WASHER FOR CHAINING POINT AT CENTER RIGHT SIDE, AND FOREST SERVICE 54-3 BEARING TREE SIGN:

BT1: A 16 INCH PINYON PINE, S06W, 6.7 FEET  
BT2: A 24 INCH PINYON PINE, N06W, 18.8 FEET

340200

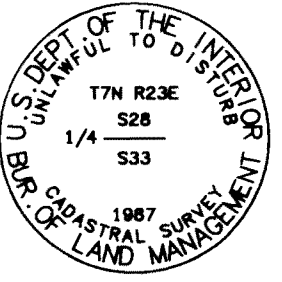

FOUND A 2 1/2 INCH STAINLESS STEEL PIPE WITH A 3/4 BRASS CAP STAMPED AS SHOWN, 6 INCHES ABOVE THE TOP OF A MOUND OF STONES, 5.0 FEET IN DIAMETER AND 24 INCHES ABOVE THE GROUND. FOUND THE MONUMENT IN FAIR CONDITION, LEANING SLIGHTLY TO THE NORTH, STRAIGHTENED THE MONUMENT AND REBUILT MOUND OF STONES. SET A U CHANNEL ALUMINUM POST WITH A FOREST SERVICE 54-9 MONUMENT SIGN, 1.5 FEET SOUTHERLY. FOUND ORIGINAL BEARING TREE:

BT1: A 40 INCH YELLOW PINE, S42.5W, 57.8 FEET

FOUND 1987 BEARING TREE:

BT2: AN 18 INCH DEAD AND FALLEN FIR, N38W, 23.8 FEET

ADDED, TO THE LIVE TREE, A FOREST SERVICE 54-3 BEARING TREE SIGN AND A 6" MAG SPIKE AND "PLS 7172" STAINLESS STEEL WASHER FOR A CHAINING POINT AT CENTER RIGHT SIDE. SET A NEW BEARING TREE SCRIBED "BT", WITH 6" MAG SPIKE AND "PLS 7172" STAINLESS STEEL WASHER FOR CHAINING POINT AT CENTER RIGHT SIDE, AND FOREST SERVICE 54-3 BEARING TREE SIGN:

BT3: A 14 INCH FIR, N30W, 33.7 FEET.

340300

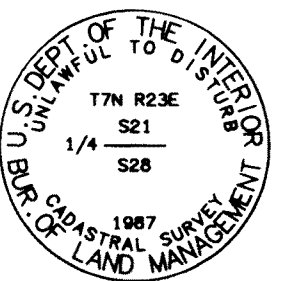

FOUND A 2 1/2 INCH STAINLESS STEEL PIPE WITH A 3/4 BRASS CAP STAMPED AS SHOWN, 6 INCHES ABOVE THE TOP OF A MOUND OF STONES, 3.0 FEET IN DIAMETER AND 10 INCHES ABOVE THE GROUND. FOUND THE MONUMENT IN FAIR CONDITION, LEANING SLIGHTLY TO THE NORTH, STRAIGHTENED THE MONUMENT AND REBUILT MOUND OF STONES TO 3.0 FEET IN DIAMETER AND 16 INCHES ABOVE THE GROUND. SET A U CHANNEL ALUMINUM POST WITH A FOREST SERVICE 54-9 MONUMENT SIGN, 1.5 FEET SOUTHERLY. FOUND ORIGINAL BEARING TREES:

BT1: A 22 INCH BURNT, DEAD, AND FALLEN YELLOW PINE (RECORD WAS S58.5W, 27.7 FEET)

BT2: A 37 INCH BURNT, DEAD, AND FALLEN YELLOW PINE (RECORD WAS N84.5W, 35.6 FEET)

FOUND 1987 BEARING TREE:

BT3: A 9 INCH BURNT, DEAD, AND FALLEN YELLOW PINE (RECORD WAS N30E, 3.3 FEET)

NO NEW BEARING TREES ESTABLISHED

340320

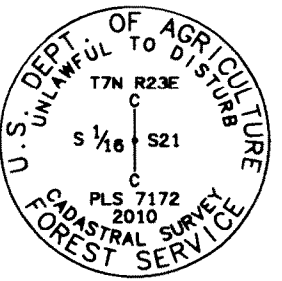

SET A STANDARD US FOREST SERVICE ALUMINUM MONUMENT WITH A 3/4 INCH DIAMETER ALUMINUM CAP, STAMPED AS SHOWN, ON A 2 1/2 INCH DIAMETER POST, 30 INCHES LONG, 24 INCHES IN THE GROUND, ENCIRCLED BY A MOUND OF STONES, 3.0 FEET IN DIAMETER AND 6 INCHES ABOVE THE GROUND. PLACED A PLASTIC ENCASED MAGNET BENEATH THE MONUMENT. SET A U CHANNEL ALUMINUM POST WITH FOREST SERVICE 54-9 MONUMENT SIGN AND A FOREST SERVICE 54-2 BOUNDARY SIGN, 2.0 FEET NORTHWESTERLY. NO NEW BEARING TREES ESTABLISHED

340340

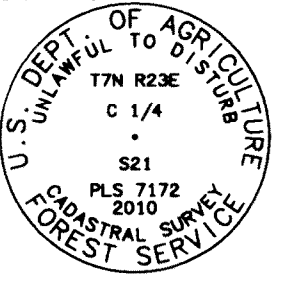

SET A STANDARD US FOREST SERVICE ALUMINUM MONUMENT WITH A 3/4 INCH DIAMETER ALUMINUM CAP, STAMPED AS SHOWN, ON A 2 1/2 INCH DIAMETER POST, 30 INCHES LONG, 24 INCHES IN THE GROUND, ENCIRCLED BY A MOUND OF STONES, 3.0 FEET IN DIAMETER AND 6 INCHES ABOVE THE GROUND. PLACED A PLASTIC ENCASED MAGNET BENEATH THE MONUMENT. SET A U CHANNEL ALUMINUM POST WITH FOREST SERVICE 54-9 MONUMENT SIGN AND A FOREST SERVICE 54-2 BOUNDARY SIGN, 1.5 FEET NORTHWESTERLY. NO NEW BEARING TREES ESTABLISHED